

**SOT-23 30V N Channel ESD Protection 沟道带静电保护**  
**MOS Field Effect Transistor 场效应管**

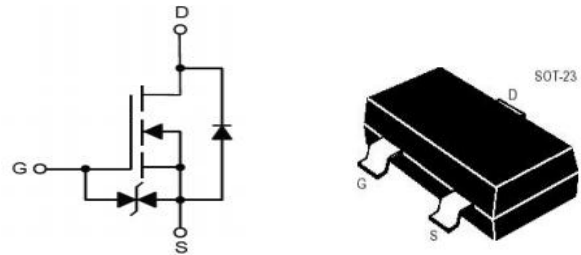

■ **Absolute Maximum Ratings 最大额定值**

Characteristic 特性参数	Symbol 符号	Rat 额定值	Unit 单位
Drain-Source Voltage 漏极-源极电压	$BV_{DSS}$	30	V
Gate- Source Voltage 栅极-源极电压	$V_{GS}$	$\pm 20$	V
Drain Current (continuous)漏极电流-连续	$I_D$ (at $T_A = 25^\circ C$ )	0.5	A
Drain Current (pulsed)漏极电流-脉冲	$I_{DM}$	1.5	A
Total Device Dissipation 总耗散功率	$P_D$ (at $T_A = 25^\circ C$ )	350	mW
ESD Protected Up to 人体模式静电保护范围	ESD(HBM)	2.0	kV
Thermal Resistance Junction-Ambient 热阻	$R_{\theta JA}$	357	$^\circ C/W$
Junction/Storage Temperature 结温/储存温度	$T_J, T_{stg}$	-55~150	$^\circ C$

■ **Device Marking 产品字标**

2SK3018=KN

■ **Electrical Characteristics 电特性**

( $T_A=25^\circ\text{C}$  unless otherwise noted 如无特殊说明, 温度为  $25^\circ\text{C}$ )

Characteristic 特性参数	Symbol 符号	Min 最小值	Typ 典型值	Max 最大值	Unit 单位
Drain-Source Breakdown Voltage 漏极-源极击穿电压( $I_D=10\mu\text{A}, V_{GS}=0\text{V}$ )	$BV_{DSS}$	30	—	—	V
Gate Threshold Voltage 栅极开启电压( $I_D=100\mu\text{A}, V_{GS}=V_{DS}$ )	$V_{GS(th)}$	0.8	1.1	1.5	V
Zero Gate Voltage Drain Current 零栅压漏极电流( $V_{GS}=0\text{V}, V_{DS}=30\text{V}$ )	$I_{DSS}$	—	—	1	$\mu\text{A}$
Gate Body Leakage 栅极漏电流( $V_{GS}=\pm 20\text{V}, V_{DS}=0\text{V}$ )	$I_{GSS}$	—	—	$\pm 10$	$\mu\text{A}$
Static Drain-Source On-State Resistance 静态漏源导通电阻( $I_D=0.3\text{A}, V_{GS}=10\text{V}$ ) ( $I_D=0.2\text{A}, V_{GS}=4.5\text{V}$ )	$R_{DS(ON)}$	—	380 535	485 700	$\text{m}\Omega$
Diode Forward Voltage Drop 内附二极管正向压降( $I_{SD}=100\text{mA}, V_{GS}=0\text{V}$ )	$V_{SD}$	—	—	1.2	V
Input Capacitance 输入电容 ( $V_{GS}=0\text{V}, V_{DS}=30\text{V}, f=1\text{MHz}$ )	$C_{ISS}$	—	28	—	pF
Common Source Output Capacitance 共源输出电容( $V_{GS}=0\text{V}, V_{DS}=30\text{V}, f=1\text{MHz}$ )	$C_{OSS}$	—	3	—	pF
Reverse Transfer Capacitance 反馈电容( $V_{GS}=0\text{V}, V_{DS}=30\text{V}, f=1\text{MHz}$ )	$C_{RSS}$	—	2	—	pF
Total Gate Charge 栅极电荷密度 ( $V_{DS}=30\text{V}, I_D=100\text{mA}, V_{GS}=10\text{V}$ )	$Q_g$	—	1.6	—	nC
Gate Source Charge 栅源电荷密度 ( $V_{DS}=30\text{V}, I_D=100\text{mA}, V_{GS}=10\text{V}$ )	$Q_{gs}$	—	0.5	—	nC
Gate Drain Charge 栅漏电荷密度 ( $V_{DS}=30\text{V}, I_D=100\text{mA}, V_{GS}=10\text{V}$ )	$Q_{gd}$	—	0.3	—	nC
Turn-ON Delay Time 开启延迟时间 ( $V_{DS}=30\text{V}, I_D=100\text{mA}, R_{GEN}=6\Omega, V_{GS}=10\text{V}$ )	$t_{d(on)}$	—	4	—	ns
Turn-ON Rise Time 开启上升时间 ( $V_{DS}=30\text{V}, I_D=100\text{mA}, R_{GEN}=6\Omega, V_{GS}=10\text{V}$ )	$t_r$	—	16	—	ns
Turn-OFF Delay Time 关断延迟时间 ( $V_{DS}=30\text{V}, I_D=100\text{mA}, R_{GEN}=6\Omega, V_{GS}=10\text{V}$ )	$t_{d(off)}$	—	20	—	ns
Turn-OFF Fall Time 关断下降时间 ( $V_{DS}=30\text{V}, I_D=100\text{mA}, R_{GEN}=6\Omega, V_{GS}=10\text{V}$ )	$t_f$	—	80	—	ns

■ Typical Characteristic Curve 典型特性曲线

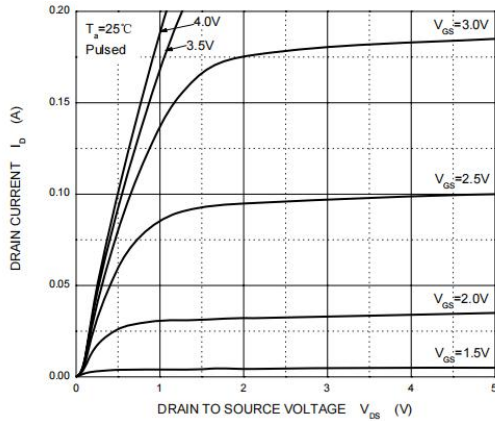

Figure 1: Output Characteristics

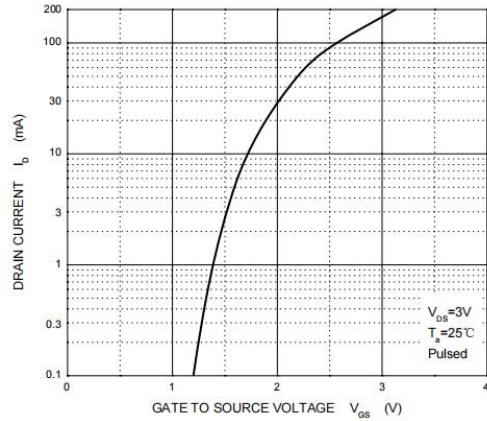

Figure 2: Transfer Characteristics

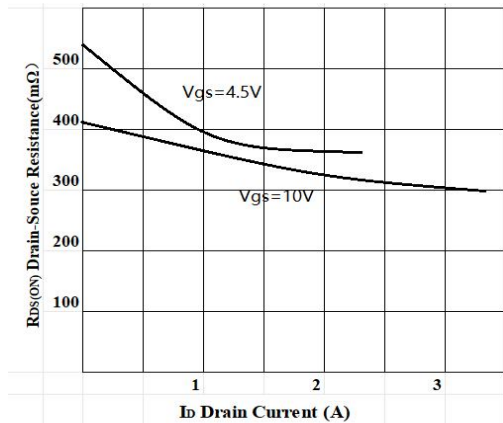

Figure 3: On-Resistance vs. Drain Current

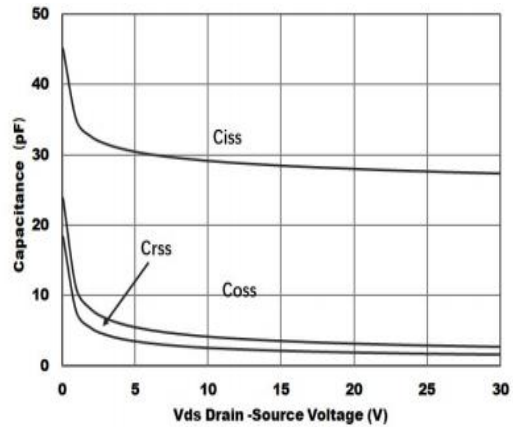

Figure 4: Capacitance Characteristics

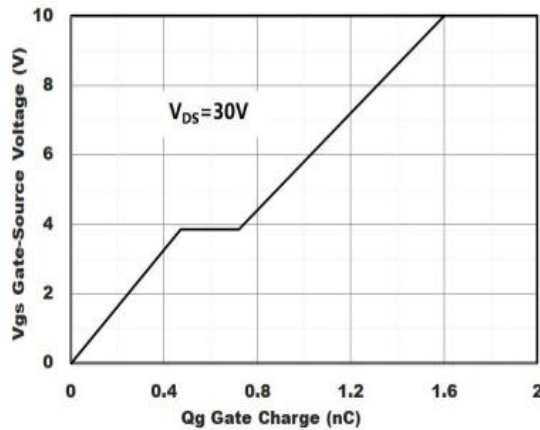
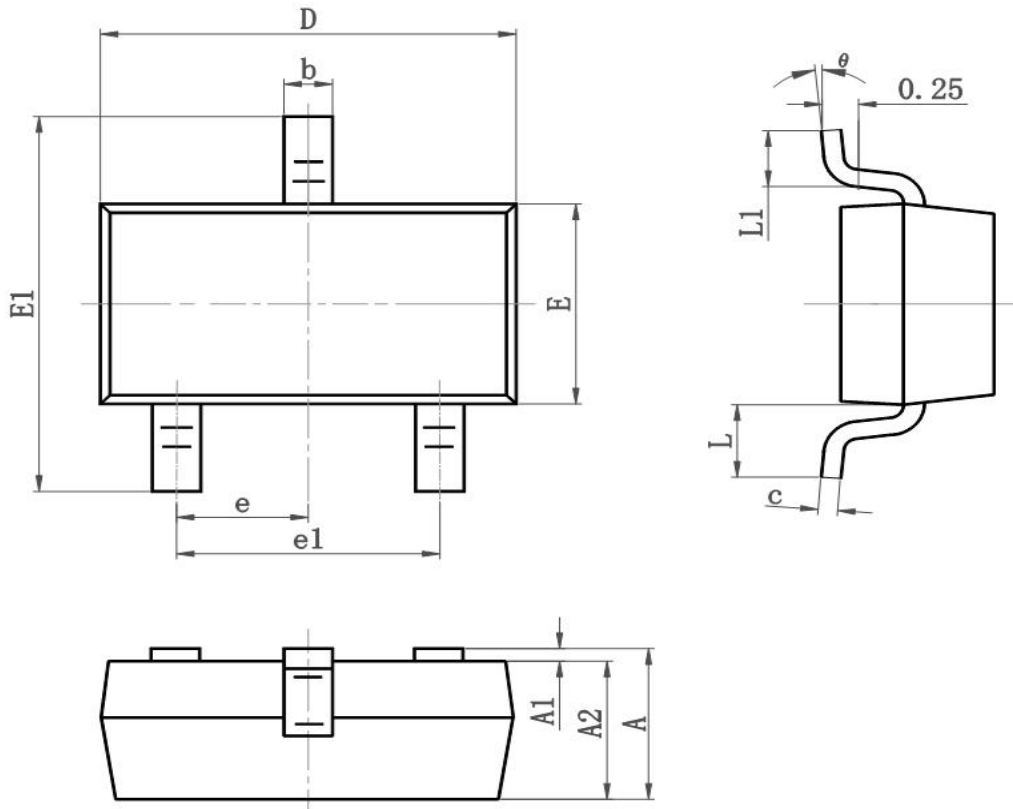

Figure 5: Gate-Charge Characteristics

■ Dimension 外形封装尺寸



Symbol	Dimensions In Millimeters		Dimensions In Inches	
	Min	Max	Min	Max
A	0.900	1.150	0.035	0.045
A1	0.000	0.100	0.000	0.004
A2	0.900	1.050	0.035	0.041
b	0.300	0.500	0.012	0.020
c	0.080	0.150	0.003	0.006
D	2.800	3.000	0.110	0.118
E	1.200	1.400	0.050	0.055
EI	2.250	2.550	0.089	0.100
e	0.900	1.00	0.035	0.039
e1	1.800	2.000	0.071	0.079
L	0.500	0.600	0.020	0.024
L1	0.300	0.500	0.012	0.020
θ	0°	8°	0°	8°