

**SOT-23 Bipolar Transistor 双极型三极管**

**SOT-23**

■ **Features 特点**

**NPN General Purpose 通用**

- 1. BASE
- 2. EMITTER
- 3. COLLECTOR

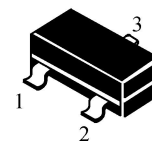

■ **Absolute Maximum Ratings 最大额定值**

| Characteristic<br>特性参数                      | Symbol<br>符号                | BC846<br>A/B/C             | BC847<br>A/B/C | BC848<br>A/B/C | Unit<br>单位                |
|---|-----------------------------|----------------------------|----------------|----------------|---------------------------|
| Collector-Base Voltage<br>集电极基极电压           | $V_{CBO}$                   | 80                         | 50             | 30             | V                         |
| Collector-Emitter Voltage<br>集电极发射极电压       | $V_{CEO}$                   | 65                         | 45             | 30             | V                         |
| Emitter-Base Voltage<br>发射极基极电压             | $V_{EBO}$                   | 6                          | 6              | 5              | V                         |
| Collector Current<br>集电极电流                  | $I_C$                       | 100                        |                |                | mA                        |
| Power dissipation<br>耗散功率                   | $P_C(T_a=25^\circ\text{C})$ | 200                        |                |                | mW                        |
| Thermal Resistance<br>Junction-Ambient 热阻   | $R_{\theta JA}$             | 625                        |                |                | $^\circ\text{C}/\text{W}$ |
| Junction and Storage Temperature<br>结温和储藏温度 | $T_J, T_{stg}$              | -55to+150 $^\circ\text{C}$ |                |                |                           |

■ **Device Marking 产品打标**

| $H_{FE}$ |       | 110-220(A) | 200-450(B) | 420-800(C) |
|----------|-------|------------|------------|------------|
| Mark     | BC846 | 1A         | 1B         | 1C         |
|          | BC847 | 1E         | 1F         | 1G         |
|          | BC848 | 1J         | 1K         | 1L         |

■ Electrical Characteristics 电特性

( $T_A=25^\circ\text{C}$  unless otherwise noted 如无特殊说明, 温度为  $25^\circ\text{C}$ )

| Characteristic<br>特性参数  |  | Symbol<br>符号  | Min<br>最小值        | Type<br>典型值       | Max<br>最大值        | Unit<br>单位 |
|---|--|---------------|-------------------|-------------------|-------------------|------------|
| Collector-Base Breakdown Voltage<br>集电极基极击穿电压<br>( $I_C=10\mu\text{A}$ , $I_E=0$ )              | BC846A/B/C<br>BC847A/B/C<br>BC848A/B/C   | $BV_{CBO}$    | 80<br>50<br>30    | —                 | —                 | V          |
| Collector-Emitter Breakdown Voltage<br>集电极发射极击穿电压<br>( $I_C=10\text{mA}$ , $I_B=0$ )            | BC846A/B/C<br>BC847A/B/C<br>BC848A/B/C   | $BV_{CEO}$    | 65<br>45<br>30    | —                 | —                 | V          |
| Emitter-Base Breakdown Voltage<br>发射极基极击穿电压<br>( $I_E=10\mu\text{A}$ , $I_C=0$ )                |  | $BV_{EBO}$    | 5                 | —                 | —                 | V          |
| Collector-Base<br>Leakage Current<br>集电极基极漏电流   | BC846A/B/C( $V_{CB}=70\text{V}, I_E=0$ )<br>BC847A/B/C( $V_{CB}=50\text{V}, I_E=0$ )<br>BC848A/B/C( $V_{CB}=30\text{V}, I_E=0$ ) | $I_{CBO}$     | —                 | —                 | 100               | nA         |
| Emitter-Base Leakage Current<br>发射极基极漏电流<br>( $V_{EB}=5\text{V}$ , $I_C=0$ )                    |  | $I_{EBO}$     | —                 | —                 | 100               | nA         |
| DC Current Gain<br>直流电流增益<br>( $V_{CE}=5\text{V}, I_C=2\text{mA}$ )                             | BC846A/BC847A/BC848A<br>BC846B/BC847B/BC848B<br>BC846C/BC847C/BC848C   | $H_{FE}$      | 110<br>200<br>420 | 180<br>290<br>520 | 220<br>450<br>800 |            |
| Collector-Emitter Saturation Voltage<br>集电极发射极饱和压降<br>( $I_C=100\text{mA}$ , $I_B=5\text{mA}$ ) |  | $V_{CE(sat)}$ | —                 | —                 | 0.5               | V          |
| Base-Emitter Saturation Voltage<br>基极发射极饱和压降<br>( $I_C=100\text{mA}$ , $I_B=5\text{mA}$ )       |  | $V_{BE(sat)}$ | —                 | —                 | 1.1               | V          |
| Transition Frequency<br>特征频率<br>( $V_{CE}=5\text{V}$ , $I_C=10\text{mA}$ )                      |  | $f_T$         | 100               | —                 | —                 | MHz        |
| Output Capacitance<br>输出电容<br>( $V_{CB}=10\text{V}$ , $I_E=0$ , $f=1\text{MHz}$ )               |  | $C_{ob}$      | —                 | 4.5               | —                 | pF         |

■ Typical Characteristic Curve 典型特性曲线

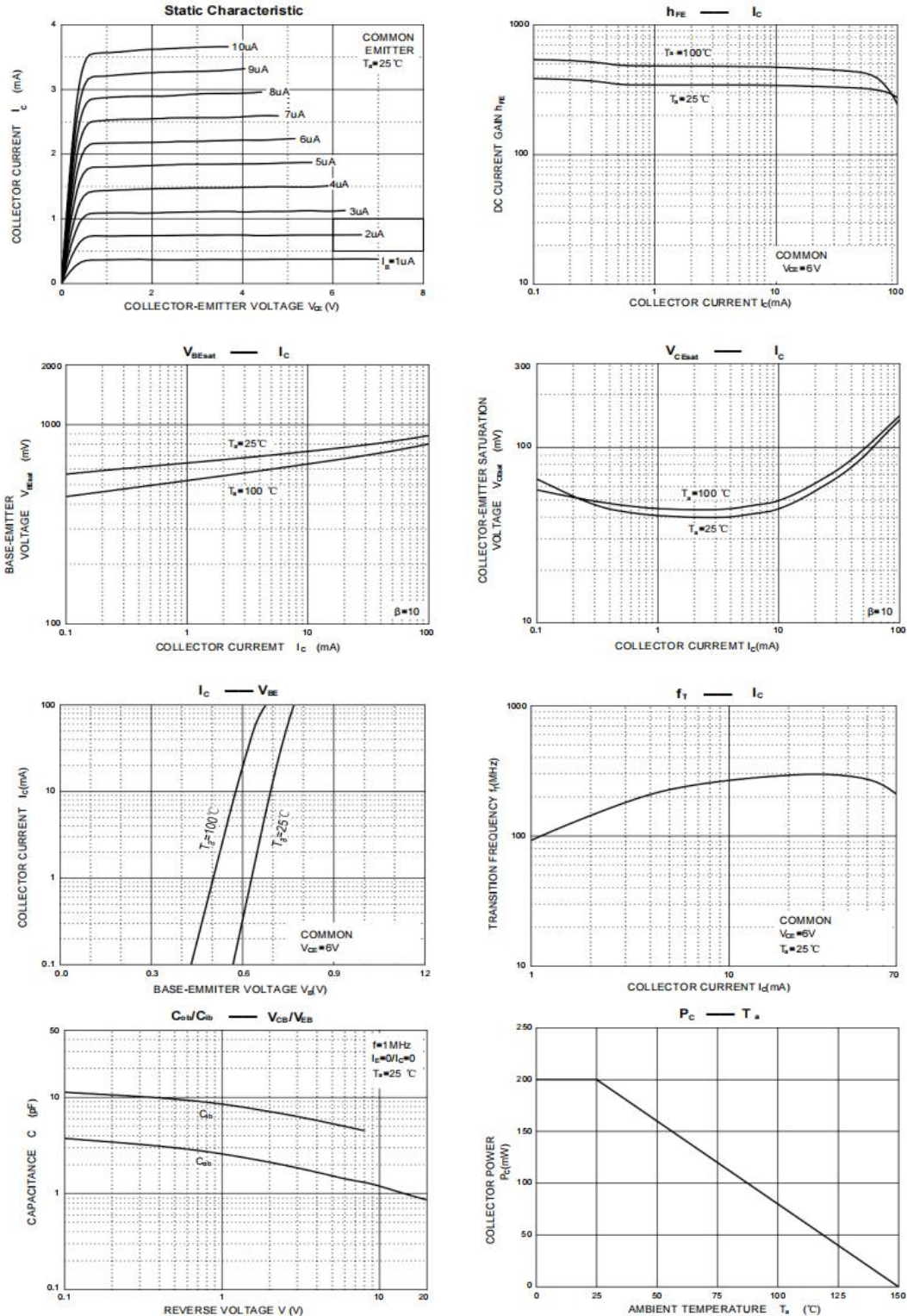

■Dimension 外形封装尺寸

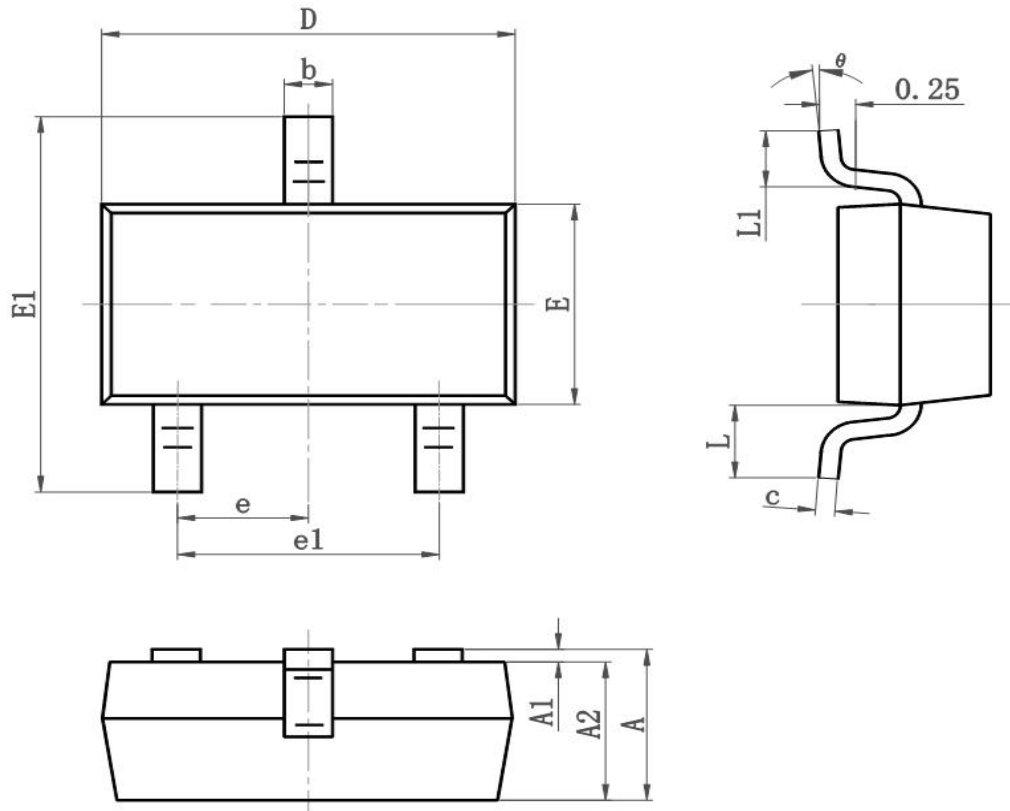

| Symbol   | Dimensions In Millimeters |       | Dimensions In Inches |       |
|----------|---------------------------|-------|----------------------|-------|
|          | Min                       | Max   | Min                  | Max   |
| A        | 0.900                     | 1.150 | 0.035                | 0.045 |
| A1       | 0.000                     | 0.100 | 0.000                | 0.004 |
| A2       | 0.900                     | 1.050 | 0.035                | 0.041 |
| b        | 0.300                     | 0.500 | 0.012                | 0.020 |
| c        | 0.080                     | 0.150 | 0.003                | 0.006 |
| D        | 2.800                     | 3.000 | 0.110                | 0.118 |
| E        | 1.200                     | 1.400 | 0.050                | 0.055 |
| E1       | 2.250                     | 2.550 | 0.089                | 0.100 |
| e        | 0.900                     | 1.00  | 0.035                | 0.039 |
| e1       | 1.800                     | 2.000 | 0.071                | 0.079 |
| L        | 0.500                     | 0.600 | 0.020                | 0.024 |
| L1       | 0.300                     | 0.500 | 0.012                | 0.020 |
| $\theta$ | 0°                        | 8°    | 0°                   | 8°    |