



**SOD-323 Schottky Barrier Diode 肖特基势垒二极管**

■ **Internal Configuration & Device Marking 内部结构与产品打标**

Type 型号	BAT54W	
Pin 管脚		
Mark 打标	L9	

■ **Absolute Maximum Ratings 最大额定值**

Characteristic 特性参数	Symbol 符号	Rat 额定值	Unit 单位
Peak Reverse Voltage 反向峰值电压	$V_{RRM}$	30	V
Reverse Work Voltage 反向工作电压	$V_{RWM}$		
DC Reverse Voltage 直流反向电压	$V_R$		
Forward Work Current 正向工作电流	$I_F(I_O)$	200	mA
Peak Forward Current 正向峰值电流	$I_{FM}$	600	mA
Power dissipation 耗散功率	$P_D(T_a=25^\circ C)$	500	mW
Thermal Resistance J-A 结到环境热阻	$R_{\theta JA}$	250	$^\circ C/W$
Junction and Storage Temperature 结温和储藏温度	$T_J, T_{stg}$	-55to+150 $^\circ C$	

■ **Electrical Characteristics 电特性**

( $T_A=25^\circ C$  unless otherwise noted 如无特殊说明, 温度为  $25^\circ C$ )

Characteristic 特性参数	Symbol 符号	Min 最小值	Max 最大值	Unit 单位
Reverse Breakdown Voltage 反向击穿电压( $I_R=10\mu A$ )	$V_{(BR)}$	30	—	V
Reverse Leakage Current 反向漏电流( $V_R=25V$ )	$I_R$	—	2	$\mu A$
Forward Voltage( $I_F=1mA$ ) 正向电压( $I_F=100mA$ )	$V_F$		0.32 1	V
Diode Capacitance 二极管电容( $V_R=1V, f=1MHz$ )	$C_D$	—	10	pF
Reverse Recovery Time 反向恢复时间	$T_{rr}$	—	5	nS

■ Typical Characteristic Curve 典型特性曲线

Fig.1 Forward Current Derating Curve

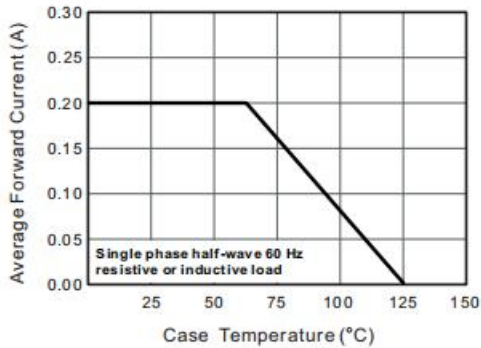

Fig.2 Typical Reverse Characteristics

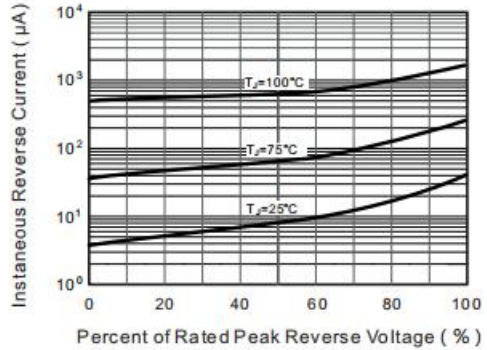

Fig.2 TYPICAL FORWARD VOLTAGE

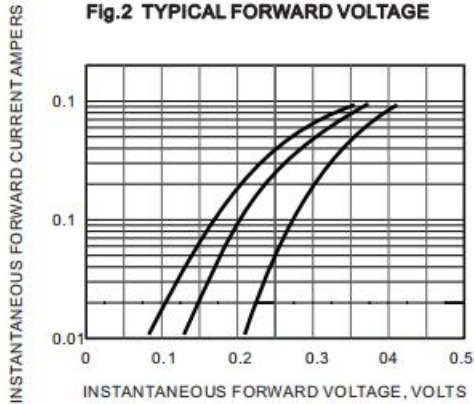

Fig.4 Typical Junction Capacitance

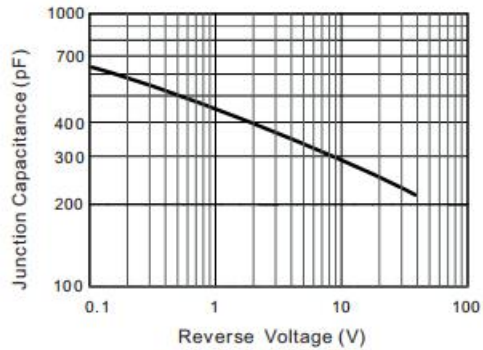
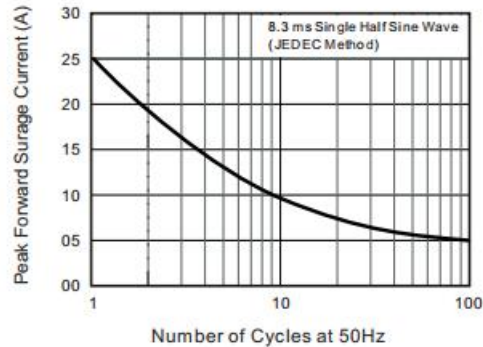
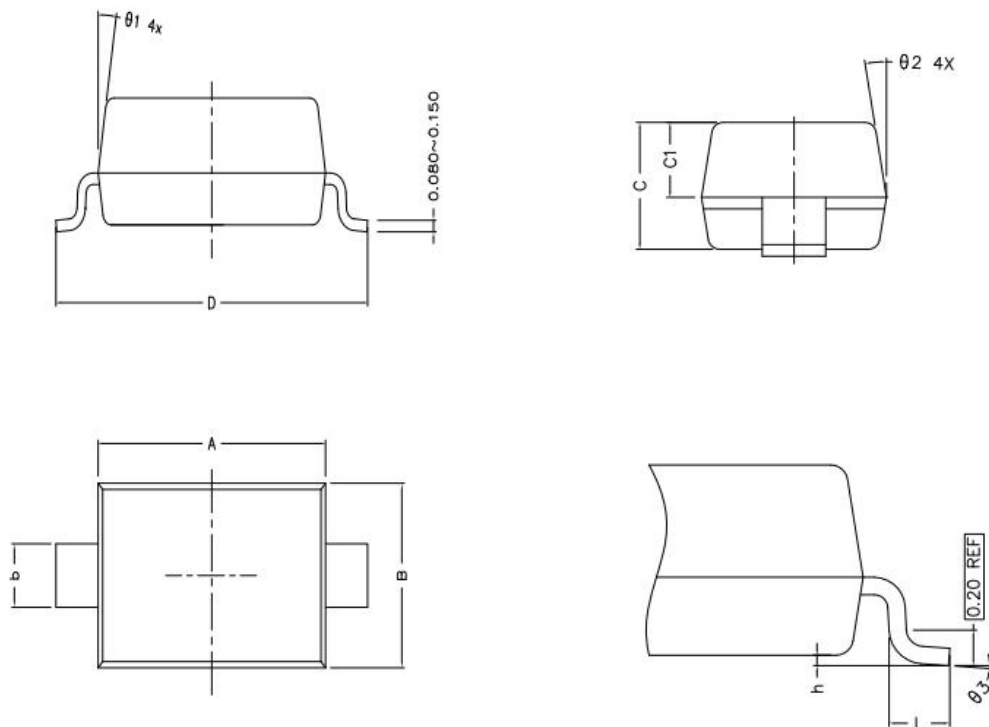

Fig.5 Maximum Non-Repetitive Peak Forward Surge Current



■Dimension 外形封装尺寸



COMMON DIMENSIONS (UNITS OF MEASURE IS mm)			
	MIN	NORMAL	MAX
A	2.600	2.700	2.800
B	1.500	1.600	1.700
C	1.050	1.100	1.150
C1	0.600	0.650	0.700
D	3.550	3.700	3.850
L	0.250	0.350	0.450
h	0.010	0.050	0.100
b	0.450	0.550	0.650
$\theta 1$	9° TYPE		
$\theta 2$	9° TYPE		
$\theta 3$	0° ~ 7°		